



HUDSON BAY 500



clippermotoryachts.com

HUDSON BAY 500

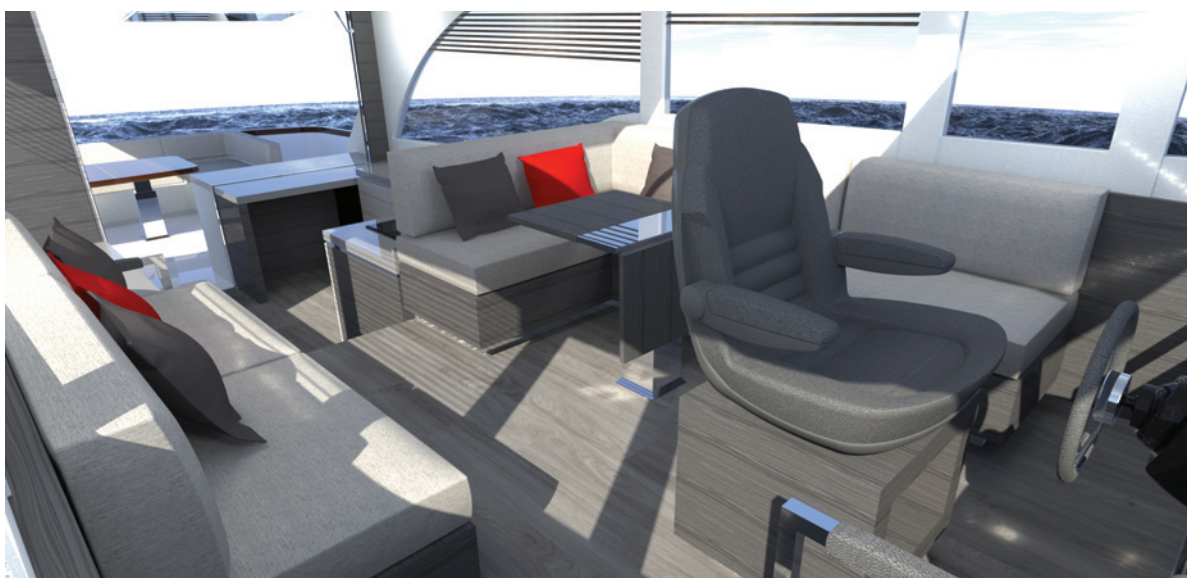
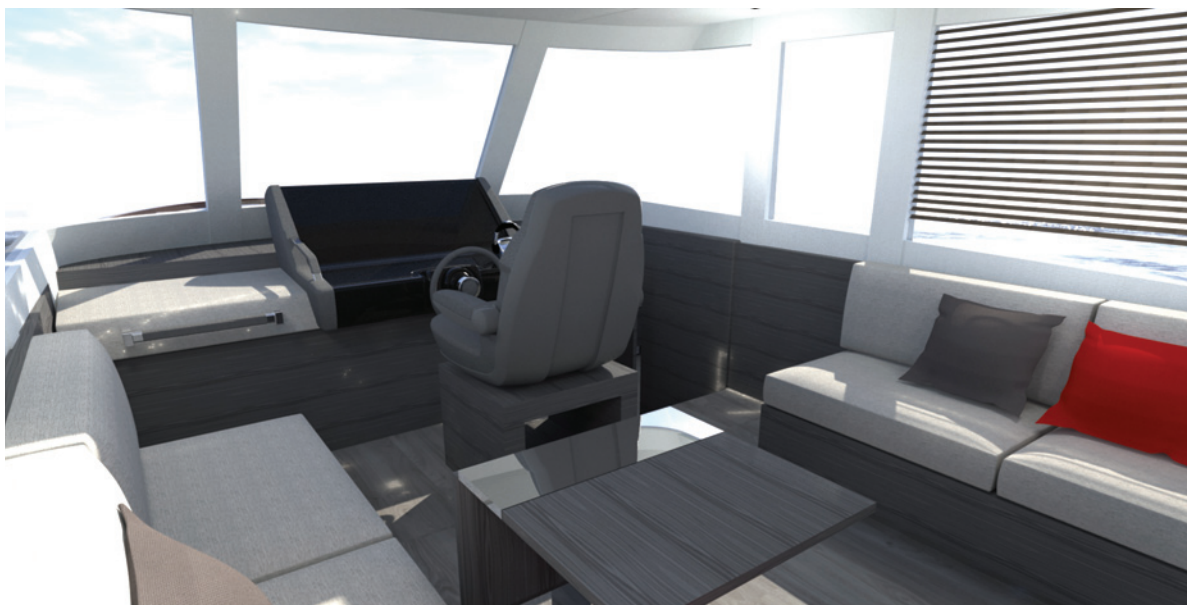

SPECIFICATIONS

Length overall (inc. swim platform & bow roller)	15.4m	50ft 6in
Beam OA	4.34m	14ft 4in
Maximum Draft	1.25m	4ft 3in
Displacement	22 tonnes (approx)	
Fuel Capacity	TBA	
Water Capacity	TBA	
Holding Tank Capacity	140 litres	
Standard Engines	Twin 425hp D6 Volvo	
Generator - Onan	13.5Kw	
Bow Thruster	220kgf Vetus or Quick	



HUDSON BAY 500

FLOOR PLANS

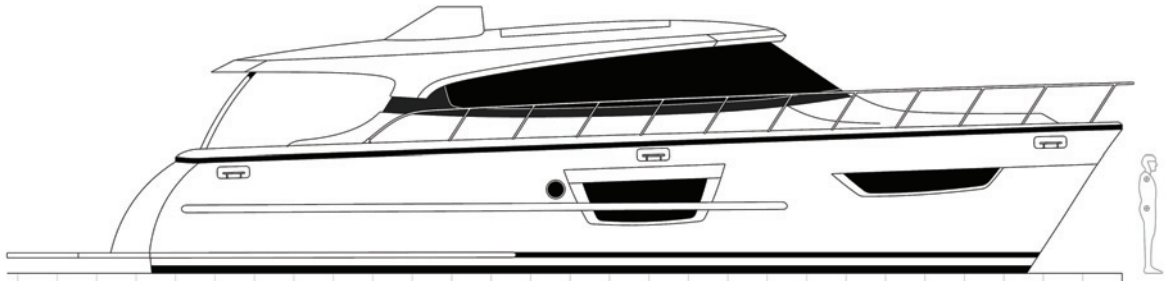
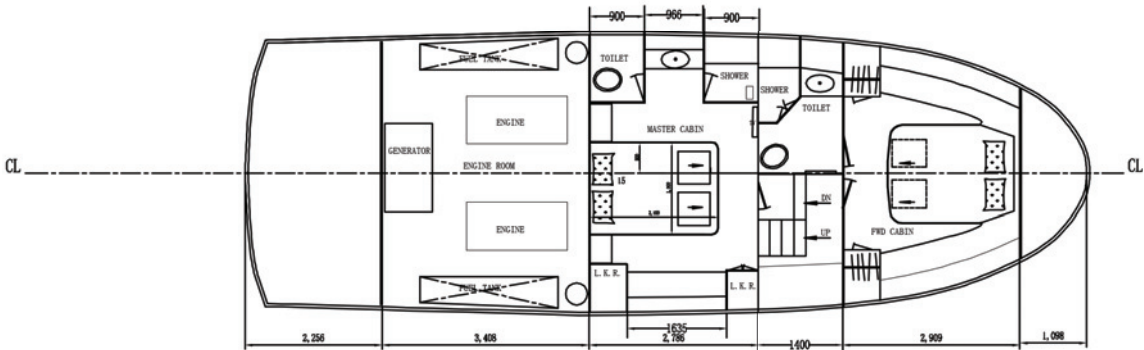
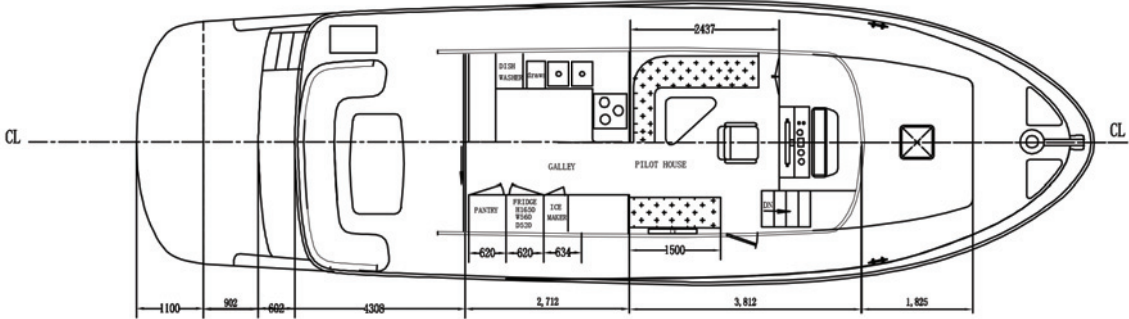

Side profile



HUDSON BAY 500

OVERVIEW

The new Hudson Bay 500 takes entertaining to the next platform. Combining a huge open plan layout with aft galley opening up to an enormous cockpit on the same level. Clipper brings the outdoors in with large opening rear doors and hinged galley windows to allow for seamless entertaining.

The two cabin layout firstly boasts a "6 star" Master Stateroom with ensuite behind the king size bed which is part of a true full width stateroom amidships. Large opening hull side windows and contemporary finishes surround you in class and luxury. Even your guests will be spoiled with a large queen size bed in the port cabin and a kids bunk cabin forward for two berths.

The 500 is born for Australian cruising and entertaining with open plan layout, huge galley with full height fridge and pull out pantry for handling guests with ease. Individualise your HB500 with a custom premium painted hull colour standard in the new Hudson Bays specification. Once at anchor you will enjoy the hydraulic swim platform and twin Volvo D8 500 HP engines which cruise at 15 knots with a top speed estimated at 19 knots. Our blue water hull design features shaft drive technology with a keeled hull protecting the underwater gear and propellers in shallow waters. Cummins joystick docking technology is available for added confidence when berthing in tricky marinas or canals.

Our new 500 Hudson Bay sedan will combine the economy, safety and stability of semi-displacement cruising with the flair, styling and design of a world class sports yacht.

STANDARD SPECIFICATIONS

CONSTRUCTION

- Hand laid molded fiberglass hull, decks and superstructure
- Gelcoat exterior – white
- Hull – Solid FRP keel, chines and bottom
- Watertight collision bulkhead forward
- Custom high gloss painted hull colour

GENERAL SPECIFICATIONS

- All stainless steel exterior fastenings – 316 marine grade
- Primer system for underwater
- Antifouling – black x 2 coats
- Limewash or walnut interior
- Cabin headlining panels finished in quality vinyl
- Deck hatch on main deck for master cabin (insect screened)

MECHANICAL

- Main Engines – Twin 425hp D6 Volvo
- Single lever electronic engine and gear controls
- Generator – Onan 13.5kw with remote start/stop panel
- Bow thruster – 220kgf
- Electric/hydraulic Trim Tabs with gauge
- Superior engine room sound proofing material – foam and

lead with aluminum cladding

- Engine exhausts to exit transom
- Groco internal sea water strainers for engines, generator and air conditioning
- Engine room air vents and blower fan – 12v DC
- Engine room blower fan outlet
- Fresh water outlet with hose in engine room
- All through hull fittings on or below the water line fitted with stainless steel or bronze ball valves.
- Bilge pumps - automatic with manual override x 4 with high water alarms and manual bilge pump x 1
- Fiberglass water/gas separator for generator
- FRP fuel tanks with baffles and cleaning manholes
- FRP water tanks with baffles (FDA approved gelcoat)
- Sight gauges on fuel tanks
- Sight gauge on water tanks with single engine option
- Fuel tank gauge at lower helm
- Air vents fitted to fuel and water tanks
- Hot water tank – AC 240v and heat exchange from main engine
- Fresh water system – pressure pump activated
- Twin Racor fuel filters with gauges for main engines
- Single Racor fuel filter for generator



HUDSON BAY 500

- Holding tank –with macerator pump for overboard discharge
- Hynautic Hydraulic steering
- Propellers - four blade (S Class)
- Rudders – stainless steel stocks and stainless steel blades fitted with anodes
- High quality stainless steel propeller shafts
- Dripless stern gland propeller shaft seal
- Heavy duty stainless steel/bronze underwater brackets with cutlass bearings
- Electric toilet – with macerator pump for discharge overboard or to holding tank via “Y” valve
- Tank capacities are total volume, usable capacity will vary due to boat trim and sea state. (Do not rely on more than 90% of tank volume being usable)

MAIN DECK

- FRP bow pulpit with stainless steel roller
- Anchor – 55lb stainless steel anchor with 100m of 10mm galvanized anchor chain
- Anchor locker with access from hatches on deck
- Anchor winch – with overload protection circuit breaker, lift foot switch on foredeck and auto anchor chain counter to helm
- Four stainless steel port holes in cabin trunk with insect screens
- FRP coating
- Stainless steel bow rail
- Non skid fiberglass fore deck
- Teak on cockpit aft deck and side decks forward to steps
- One boarding door in transom and one boarding door in starboard side bulwark
- Stainless steel fuel, fresh water and waste caps recessed into superstructure
- Cleats – stainless steel x 6
- Stainless steel swim ladder

NAVIGATION EQUIPMENT

- Garmin E127W – 12” Widescreen Chart Plotter/Fish Finder/Radar to helm station
- Garmin P70 Auto pilot control
- VHF Marine radio
- Auto Anchor Chain Counters

ELECTRICAL

- LED lighting throughout
- Batteries – 2 x 200amp 12v for house, 1 x 200amp 12v for engine start, 1 x 95amp 12v for generator start, 1 x 200amp 12v for bow thruster
- Battery charger – automatic 50amp/12v DC
- Battery disconnect switches
- Battery paralleling system for emergency engine starting
- Anchor winch – 12v DC with circuit breaker at lower helm
- Full copper bonding system attached to all metallic hull fittings under the water line with zinc anodes
- Engine monitoring including instrumentation, alarms and hour meters
- AC circuit breaker panel near helm
- DC circuit breaker panel near helm
- AC power outlets (doubles) to staterooms, head, galley, engine room and lazarette with (RCD) protection
- Saloon and cabin lighting – 12v DC
- Lazarette lighting – 12v DC
- Engine room lighting – 12v DC
- Engine room blower fan – 12v DC
- Exhaust fan in head – 12v DC
- Search light – 12v DC
- Generator – Onan 13.5kw with remote stop/start electronic panel
- Navigation lights (international standard)
- BEP main switch panel
- AC 240v 15amp shore power inlet in cockpit
- Shore power lead – 15amp
- Air conditioning between cabins
- Auto Anchor Chain Counter

AUDIO/VISUAL

- 32” Flat screen LED TV on electric lift

Television size and brand may vary due to model availability and technology changes at the time of installation

COCKPIT

- Self draining cockpit to both port and starboard sides
- Hand held hot/cold fresh water shower
- Hatch – access to lazarette with gas struts and stainless steel latch
- Shore power inlet (AC)
- Lighting – 12v DC overhead
- Transom boarding door
- Wash down tap – seawater
- Transom seat and table



HUDSON BAY 500

SALOON/GALLEY

- Companionway steps with engine room access under
- Engine room access hatch in saloon floor with ladder
- Microwave/convection oven in galley
- Isotherm fridge/freezer – full height
- Galley benchtop in Stone with double stainless steel sink and good quality faucet
- Four element ceramic cooktop (AC) in galley bench top
- Galley storage – overhead cabinets with fittings for cups/plates/crockery and various drawers
- Saloon lounge – U shaped settee with Ultra Leather trim and teak hi-lo table
- 2 seater sofa
- Cabinet with 32" LED TV on electric lift
- AC outlets
- Insect screens on all opening windows
- Galley exhaust fan – 12v DC
- Wood sole
- Lighting – overhead down lights 12v DC
- Access sliding doors x 2 – aluminum side door and stainless steel back door
- Stainless hopper window open to Cockpit

MASTER STATEROOM – MIDSHIPS

- Wood sole
- Island bed with 4 drawers fitted under
- Mattress – 6" thick innerspring
- Insect screens on all opening portholes
- Large portholes in hull sides
- Wardrobe – cedar lined with auto lighting (DC)
- Deck hatch – with screen
- AC outlets
- Reading lights – 2 x lights (one either side of bed)
- Main lighting – 12v DC overhead down lights
- Storage under berth

FORWARD GUEST CABIN

- Two single berths which can combine to a double
- 6" Foam mattress
- Air conditioning outlets
- Cedar lined hanging locker with auto light
- Insect screens on portholes
- Wood sole
- 12v DC down lights
- 12v DC reading lights x 2
- 240v AC outlets
- Quality door lock
- Hatch to fore deck with screen

PORT GUEST CABIN

- Wood sole
- Hanging locker – cedar lined with automatic light (DC)
- AC outlets
- Porthole insect screens
- Two single beds (can convert to double)
- Reading lights – for each bed (12v DC)
- Main lighting – overhead down lights (12v DC)

HEAD – ENSUITE

- All white FRP with acrylic mirrored ceiling
- Two way bathroom with lockable doors (can be ensuite for Master Stateroom or bathroom to Port Cabin)
- Shower stall with hot/cold water to shower sump
- FRP floor with teak grating in shower
- Glass shower door
- Lighting – overhead down lights (12v DC)
- Insect screen on porthole
- Staron counter top with sink and faucet
- Mirror with light
- Toilet roll holder, towel holder/s and accessories
- Electric toilet with macerator pump – fresh and salt
- Three way "Y" valve for toilet discharge overboard or to holding tank
- Exhaust fan – 12v DC

HELM STATION

- Complete engine instrumentation with alarms
- Engine hour meters
- Electric horn with single trumpet
- Three electric windshield wipers and washers (12v DC)
- Electronic engine/gear controls
- Electric Trim Tab controls with gauge
- Auto Anchor up/down winch control and chain counter
- Compass – 4.75" with light
- Hydraulic steering
- Fuel and water gauges
- Handmade teak steering wheel
- Electric bilge pump switches and high water alarms
- Helm seat with footrest

GENERAL – ACCOMMODATION and INTERIOR

- Hand rubbed panelling and carpentry in all spaces
- Wood interior flooring soles throughout except engine room and shower/head
- Soft vinyl removable panel headliners (cream colour)
- Interior finish varnish – gloss or semi gloss
- High quality door locks to saloon and cabins



HUDSON BAY 500



FIRE FIGHTING EQUIPMENT

- Automatic/manual engine room fire fighting system by Sea Fire or Fireboy
- Three portable hand held extinguishers
- Fire blanket in Galley

MISCELLANEOUS

- Zinc anodes on rudders, propeller shafts, transom and trim tabs
- Spliced mooring lines x 4
- Fenders with spliced lines x 3
- Safety equipment including EPIRB, life jackets, flares and V sheet
- Black boot stripe approx. 130mm with 25mm gap to black antifouling
- Antifouling – Jotun or International brand
- Owners manual

Clipper Motor Yachts Australia Pty Ltd reserves the right to alter prices and specifications subject to currency exchange rates. Please check with Clipper Motor Yachts Australia Pty Ltd to confirm current validity. Clipper Motor Yachts Australia Pty Ltd will not be liable "in contract or otherwise" for any loss resulting from the inaccuracy of any information contained in this document. Safety equipment – each state or Territory has different safety equipment standards it is important to ensure the requirements in your jurisdiction are met prior to the vessel being used. Appropriate deposits paid to Clipper Motor Yachts Australia Pty Ltd at time of order will establish firm pricing. [3664 2/2018]

** All prices quoted etc are ex Clipper Motor Yachts Australia office at Gold Coast City Marina, Queensland, Australia

**** Denotes tank capacity. For useable capacity do not rely on more than 90% of tank capacity. Actual useable capacity will vary according to boat trim and sea state.

Clipper Motor Yachts Australia
Gold Coast City Marina
76-84 Waterway Drive, Coomera Qld 4209
Ph: +61 7 5519 4019
Fax: +61 7 5519 3748
Email: brett@clippermotoryachts.com
Web: www.clippermotoryachts.com

